

PLAN  
(1:1000)

LEVEL DATUM = 20.00

PROPOSED LEVELS	EXISTING LEVELS	CHAINAGE
10.153	8.82	1640.000
10.236	8.92	1650.000
10.319	9.02	1660.000
10.402	9.12	1670.000
10.485	9.22	1680.000
10.568	9.32	1690.000
10.651	9.42	1700.000
10.734	9.52	1710.000
10.817	9.62	1720.000
10.900	9.72	1730.000
10.983	9.82	1740.000
11.066	9.92	1750.000
11.149	10.02	1760.000
11.232	10.12	1770.000
11.314	10.22	1780.000
11.397	10.32	1790.000
11.480	10.42	1800.000
11.563	10.52	1810.000
11.646	10.62	1820.000
11.686	10.68	1824.838
11.729	10.74	1830.000
11.812	10.80	1840.000
11.895	10.86	1850.000
11.978	10.92	1860.000
12.061	10.98	1870.000
12.144	11.04	1880.000
12.227	11.10	1890.000
12.284	11.16	1896.843
12.310	11.18	1900.000
12.393	11.24	1910.000
12.476	11.30	1920.000
12.559	11.36	1930.000
12.642	11.42	1940.000
12.725	11.48	1950.000
12.798	11.54	1958.564
12.808	11.56	1960.000
12.891	11.62	1970.000
12.974	11.68	1980.000
13.056	11.74	1990.000
13.139	11.80	2000.000
13.222	11.86	2010.000
13.305	11.92	2020.000
13.387	11.98	2025.427
13.454	12.04	2030.000
13.479	12.06	2044.564
13.485	12.07	2045.199
13.508	12.09	2050.000
13.556	12.14	2060.000
13.606	12.19	2070.000
13.656	12.24	2080.000
13.706	12.29	2090.000
13.756	12.34	2100.000
13.806	12.39	2110.000
13.856	12.44	2120.000
13.906	12.49	2130.000
13.956	12.54	2140.000
14.006	12.59	2150.000
14.056	12.64	2160.000
14.106	12.69	2170.000
14.156	12.74	2180.000
14.206	12.79	2190.000
14.256	12.84	2200.000
14.306	12.89	2210.000
14.353	12.94	2219.444

LONGITUDINAL SECTION  
(CHAINAGES: 1800m - 2115m)  
(H: 1:1000 V: 1:200)

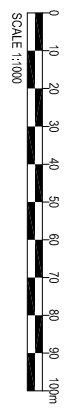
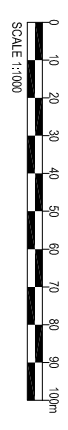

**PROJECT**  
 WYLFA  
 A5025 HIGHWAY IMPROVEMENTS  
**CLIENT**



**HORIZON NUCLEAR POWER**  
 Sunrise House, 1420 Charlton Court,  
 Gloucester Business Park, Gloucester,  
 GL3 4AE // Tel: 0845 300 6816  
 www.horizontuclearpower.com

**CONSULTANT**  
 AECOM Manchester  
 Bridgewater House, Whitworth Street,  
 Manchester, M1 6LT  
 0161 907 3500 tel 0161 907 3599 fax  
 www.aecom.com

**KEY**

- PLANNING APPLICATION RED LINE BOUNDARY
- PROPOSED CARRIAGEWAY
- PROPOSED SHARED USE FOOTWAY/CYCLEWAY
- PROPOSED VERGE
- PROPOSED FARM ACCESS TRACK
- PROPOSED EARTHWORKS SLOPES
- PROPOSED WATERCOURSE
- PROPOSED ATTENUATION POND
- PROPOSED HIGHWAY BOUNDARY FENCE
- PROPOSED GATED PUA
- PROPOSED LAND DRAINAGE DITCH
- PROPOSED VEHICLE SAFETY BARRIER

**NOTES**

1. DRAWN AT SCALE 1:1000 @ A1.
2. ALL EARTHWORKS BATTER SLOPES ARE SHOWN AT A GRADIENT OF 1 IN 2.5.
3. EXISTING GROUND LEVELS BASED ON TOPOGRAPHICAL SURVEY INFORMATION FROM BNSK SURVEYS UNDER PASSED ORDER REFERENCE VV1011517.2.mxd WITH 1.0m HARDSHORES ON BOTH SIDES OF THE ROAD. ALIGNMENT GEOMETRY HAS BEEN DESIGNED IN ACCORDANCE WITH DMRB TD 1607.
4. ROUNDABOUT GEOMETRY HAS BEEN DESIGNED IN ACCORDANCE WITH DMRB TD 1607.
5. ROUNDABOUT GEOMETRY HAS BEEN DESIGNED IN ACCORDANCE WITH DMRB TD 1607.
6. ROUNDABOUT GEOMETRY HAS BEEN DESIGNED IN ACCORDANCE WITH DMRB TD 1607.
7. FOR DETAILS OF PROPOSED DRAINAGE REFER TO DRAWINGS WN02.05-ACM-S5-DRG-001 & 002.

**ISSUE/REVISION**

IR	DATE	DESCRIPTION
P1	18.11.16	ISSUED FOR INFORMATION

PROJECT NUMBER  
47071078

SHEET TITLE  
SECTION 3

PROPOSED GENERAL ARRANGEMENT  
SHEET 4 OF 4

SHEET NUMBER

WN02.05-ACM-S3-00-DRG-104 P1



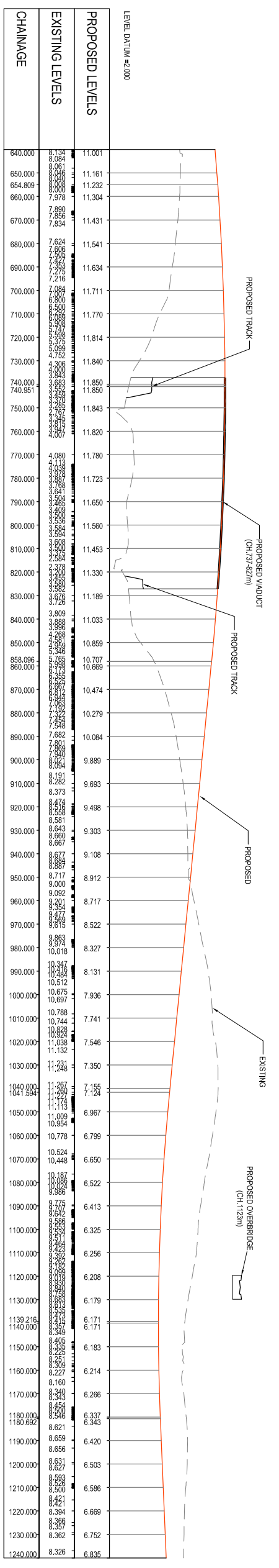
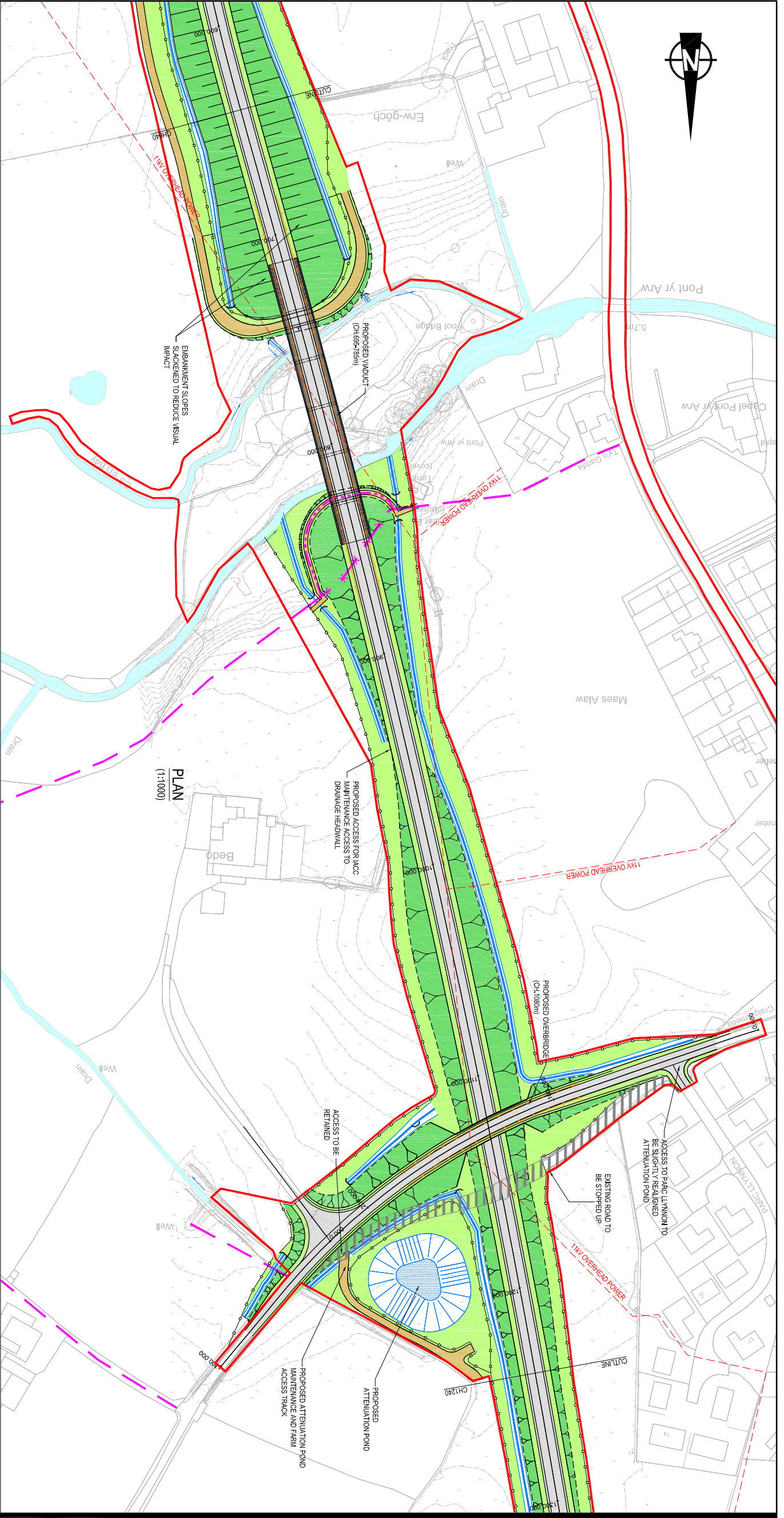

LONGITUDINAL SECTION  
 (CHAINAGES: 600m - 1200m)  
 (H: 1:1000 V: 1:200)

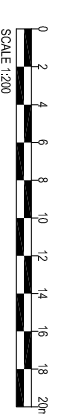
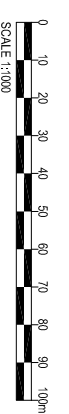

**PROJECT**  
 WYLFA  
 A5025 HIGHWAY IMPROVEMENTS  
**CLIENT**



**HORIZON NUCLEAR POWER**  
 Sunrise House, 1420 Charlton Court,  
 Gloucester Business Park, Gloucester,  
 GL3 4AE // Tel: 0845 300 6816  
 www.horizontuclearpower.com

**CONSULTANT**  
 AECOM Manchester  
 Biddewater House, Whitworth Street,  
 Manchester, M1 6LT  
 0161 907 3500 tel 0161 907 3599 fax  
 www.aecom.com

**KEY**

- PLANNING APPLICATION RED LINE BOUNDARY
- PROPOSED CARRIAGEWAY
- PROPOSED SHARED USE FOOTWAY/CYCLEWAY
- PROPOSED VERGE
- PROPOSED EARTHWORKS SLOPES
- PROPOSED FARM ACCESS TRACK
- EXISTING WATERCOURSE
- PROPOSED ATTENUATION POND
- PROPOSED HIGHWAY BOUNDARY FENCE
- PROPOSED GATED PUA
- PROPOSED LAND DRAINAGE DITCH
- PROPOSED VEHICLE SAFETY BARRIER

**NOTES**

1. DRAWN AT SCALE 1:1000 @ A1.
2. ALL EARTHWORKS BATTER SLOPES ARE SHOWN AT A GRADIENT OF 1 IN 2.5.
3. EXISTING GROUND LEVELS BASED ON TOPOGRAFICAL SURVEY INFORMATION FROM RISK SURVEYS UNDERTAKEN IN 2015 BY WYLLFA WITH 10m HARDSHIPES ON BOTH SIDES OF THE ROAD ALIGNMENT GEOMETRY HAS BEEN DESIGNED IN ACCORDANCE WITH DMRB TD 993.
4. ROUNDABOUT GEOMETRY DESIGNED IN ACCORDANCE WITH DMRB TD 1607.
5. FOR DETAILS OF PROPOSED DRAINAGE REFER TO DRAWINGS WN02-05-ACM-S5-DRG-001 & 002.

**ISSUE/REVISION**

PI	DATE	ISSUED FOR COMMENT
P1	18.11.16	
JIR		DESCRIPTION

**PROJECT NUMBER**  
 47071078

**SHEET TITLE**  
 SECTION 3  
 PROPOSED GENERAL ARRANGEMENT  
 SHEET 2 OF 4

**SHEET NUMBER**  
 WN02-05-ACM-S3-00-DRG-102 P1

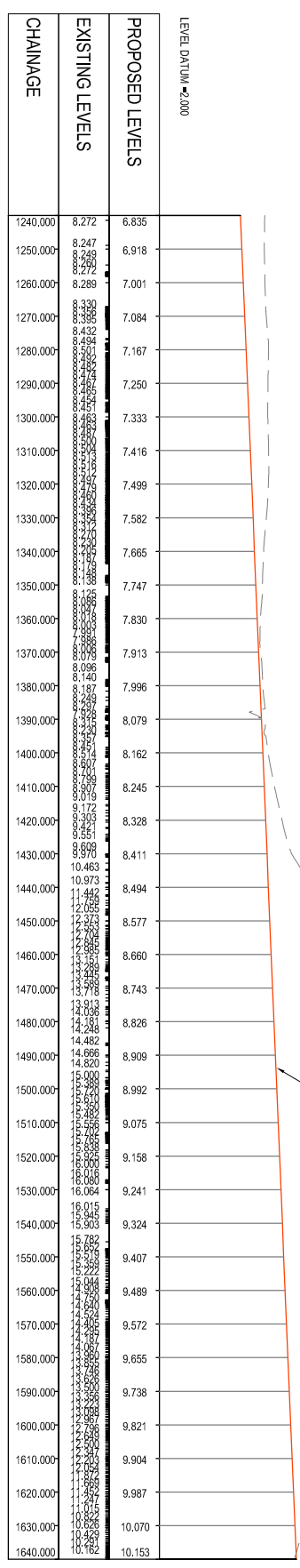
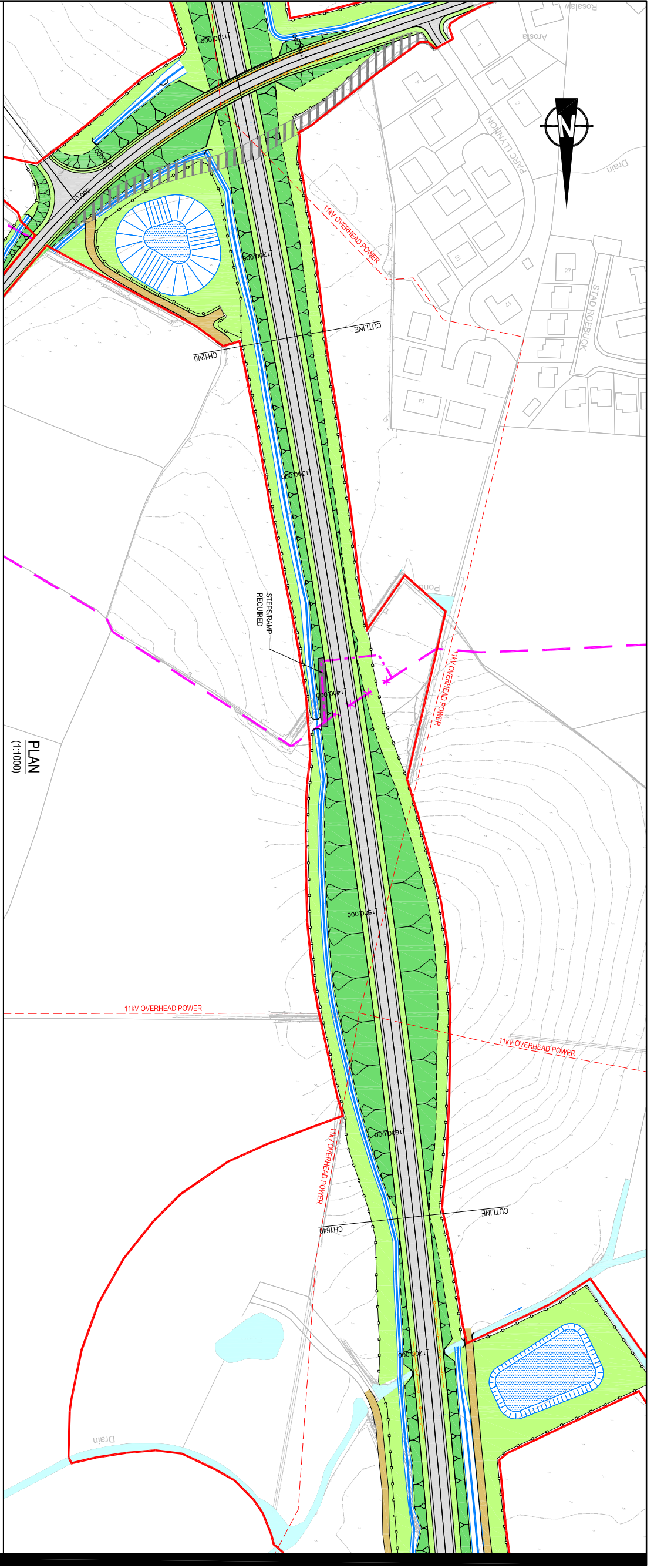

**LONGITUDINAL SECTION**  
 (CHAINAGES: 1200m - 1800m)  
 (H: 1:1000 V: 1:200)

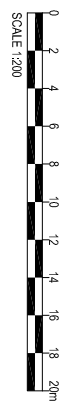
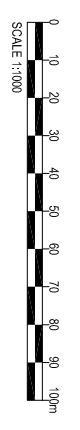

**AECOM**

**PROJECT**  
 WYLFA  
 A5025 HIGHWAY IMPROVEMENTS  
 CLIENT

**HORIZON**  
 NUCLEAR POWER

**HORIZON NUCLEAR POWER**  
 Sunrise House, 1420 Chanton Court,  
 Gloucester Business Park, Gloucester,  
 GL3 4AE // Tel: 0845 300 6816  
 www.horizondisplaypower.com

**CONSULTANT**  
 AECOM Manchester  
 Bidevaier House, Whitworth Street,  
 Manchester, M1 6LT  
 0161 907 3500 tel 0161 907 3599 fax  
 www.aecom.com

**KEY**

- PLANNING APPLICATION RED LINE BOUNDARY
- PROPOSED CARRIAGEWAY
- PROPOSED SHARED USE FOOTWAY/CYCLEWAY
- PROPOSED VERGE
- PROPOSED EARTHWORKS SLOPES
- PROPOSED FARM ACCESS TRACK
- EXISTING WATERCOURSE
- PROPOSED ATTENUATION POND
- PROPOSED HIGHWAY BOUNDARY FENCE
- PROPOSED GATED PUA
- PROPOSED LAND DRAINAGE DITCH
- PROPOSED VEHICLE SAFETY BARRIER

- NOTES**
- DRAWN AT SCALE 1:1000 @ A1.
  - ALL EARTHWORKS BATTER SLOPES ARE SHOWN AT A GRADIENT OF 1 IN 2.5.
  - EXISTING GROUND LEVELS BASES ON TOPOGRAFICAL SURVEY INFORMATION FROM RISK SURVEYS UNDERTAKEN IN CONNECTION WITH THIS PROJECT.
  - THE PROPOSED CARRIAGEWAY WIDTHS 7.3m WIDE WITH 1.0m HARDSTRIPS ON BOTH SIDES OF THE CARRIAGEWAY PROVIDING A 9.3m TOTAL PAVED WIDTH.
  - ROAD ALIGNMENT GEOMETRY HAS BEEN DESIGNED IN ACCORDANCE WITH DMRB TD 993.
  - ROUNDABOUT GEOMETRY DESIGNED IN ACCORDANCE WITH DMRB TD 1607.
  - FOR DETAILS OF PROPOSED DRAINAGE REFER TO DRAWINGS WNO2-05-ACM-S5-05-DRG-001 & 002.

**ISSUE/REVISION**

NO.	DATE	DESCRIPTION
P1	18.11.16	ISSUED FOR COMMENT

**PROJECT NUMBER**  
 47071078

**SHEET TITLE**  
 SECTION 3  
 PROPOSED GENERAL ARRANGEMENT  
 SHEET 3 OF 4  
**SHEET NUMBER**  
 WNO2-05-ACM-S3-05-DRG-103 P1

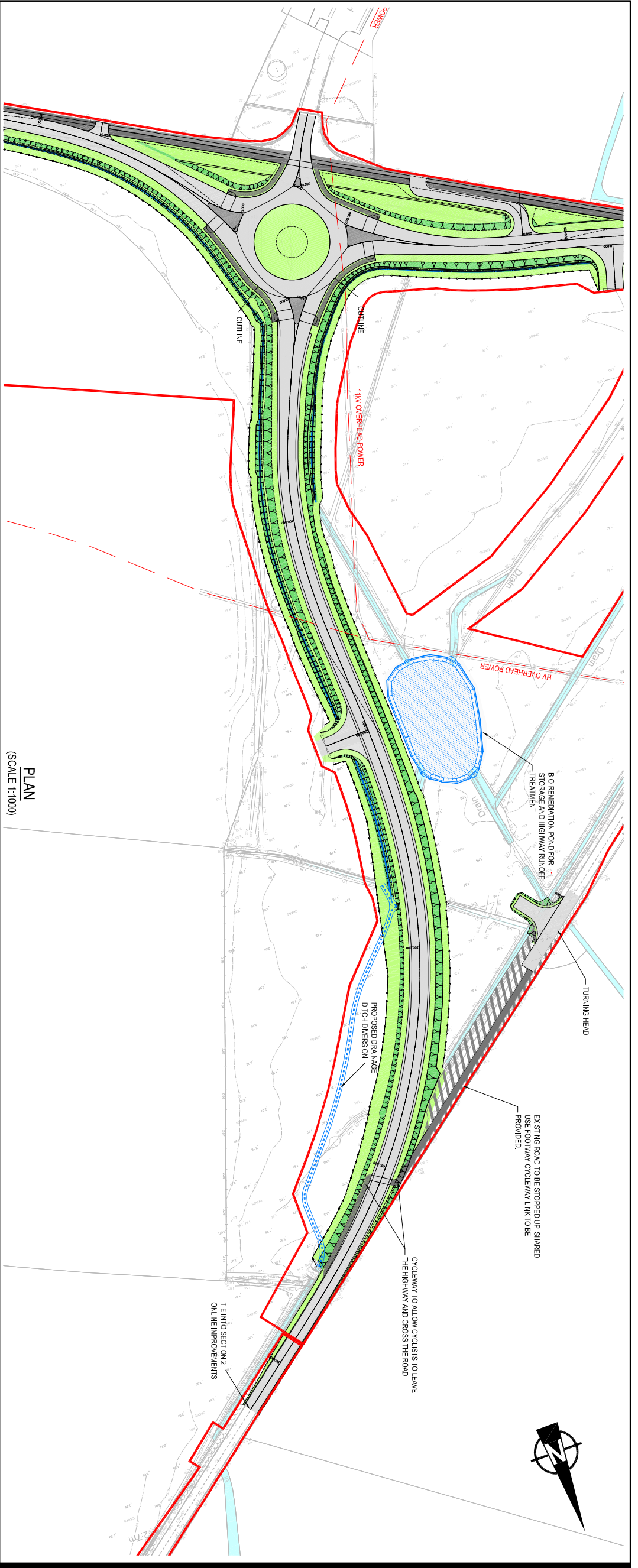

PLAN  
(SCALE 1:1000)

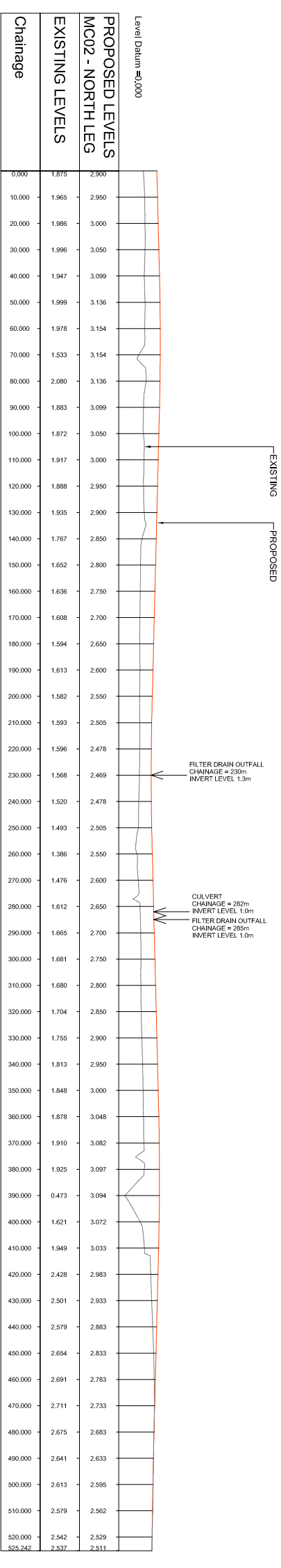

LONGITUDINAL SECTIONS  
(SCALE 1:1000H & 1:200V)

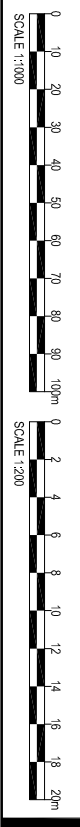

# AECOM

**PROJECT**  
 WYLFA  
 A5025 HIGHWAY IMPROVEMENTS  
 CLIENT

## HORIZON NUCLEAR POWER

**HORIZON NUCLEAR POWER**  
 Sunrise House, 1420 Charlton Court,  
 Gloucester Business Park, Gloucester,  
 GL3 4AE // Tel: 0845 300 6816  
 www.horizonnuclearpower.com

**CONSULTANT**

**AECOM Manchester**  
 Bridgewater House, Whitworth Street,  
 Manchester, M1 6LT  
 0161 907 3500 tel 0161 907 3599 fax  
 www.aecom.com

**KEY**

- PLANNING APPLICATION RED LINE BOUNDARY
- PROPOSED CARRIAGEWAY
- PROPOSED SEGREGATED FOOTWAY-CYCLEWAY
- PROPOSED SHARED USE FOOTWAY-CYCLEWAY
- PROPOSED VERGE
- PROPOSED EARTHWORKS SLOPES
- EXISTING WATERCOURSE
- PROPOSED ATTENUATION POND
- PROPOSED HIGHWAY BOUNDARY FENCE
- PROPOSED GATED PIAA
- PROPOSED LAND DRAINAGE DITCH
- PROPOSED DRAINAGE DITCH DIVERSION

**NOTES**

1. DRAWN AT SCALE 1:1000 @ A1.
2. ALL EARTHWORKS BATTER SLOPES ARE SHOWN AT A 1:1 SLOPE UNLESS OTHERWISE STATED.
3. EXISTING GROUNDLEVELS BASED ON TOPOGRAPHICAL SURVEY INFORMATION FROM RSK SURVEYS UNDERTAKEN IN DECEMBER 2014.
4. THE PROPOSED CARRIAGEWAY WIDTH IS 7.2m WIDE WITH 1.0m HARDSTRIPS ON BOTH SIDES OF THE CARRIAGEWAY PROVIDING A 9.3m TOTAL PAVED WIDTH. ROAD ALIGNMENT GEOMETRY HAS BEEN DESIGNED IN ACCORDANCE WITH DMRB TD 983.
5. ROUNDABOUT GEOMETRY DESIGNED IN ACCORDANCE WITH DMRB TD 1607.
6. FOR DETAILS OF PROPOSED DRAINAGE REFER TO DRAWINGS WN02.05-ACM-S1-05-DRG-001 & 002.

**ISSUE/REVISION**

NO.	DATE	DESCRIPTION
P1	04.11.16	ISSUED FOR COMMENT
JR		

**PROJECT NUMBER**  
 47071078

**SHEET TITLE**  
 SECTION 1

**PROPOSED GENERAL ARRANGEMENT**  
 SHEET 2 OF 2

**SHEET NUMBER**  
 WN02.05-ACM-S1-00-DRG-102 P1